

Soils Map

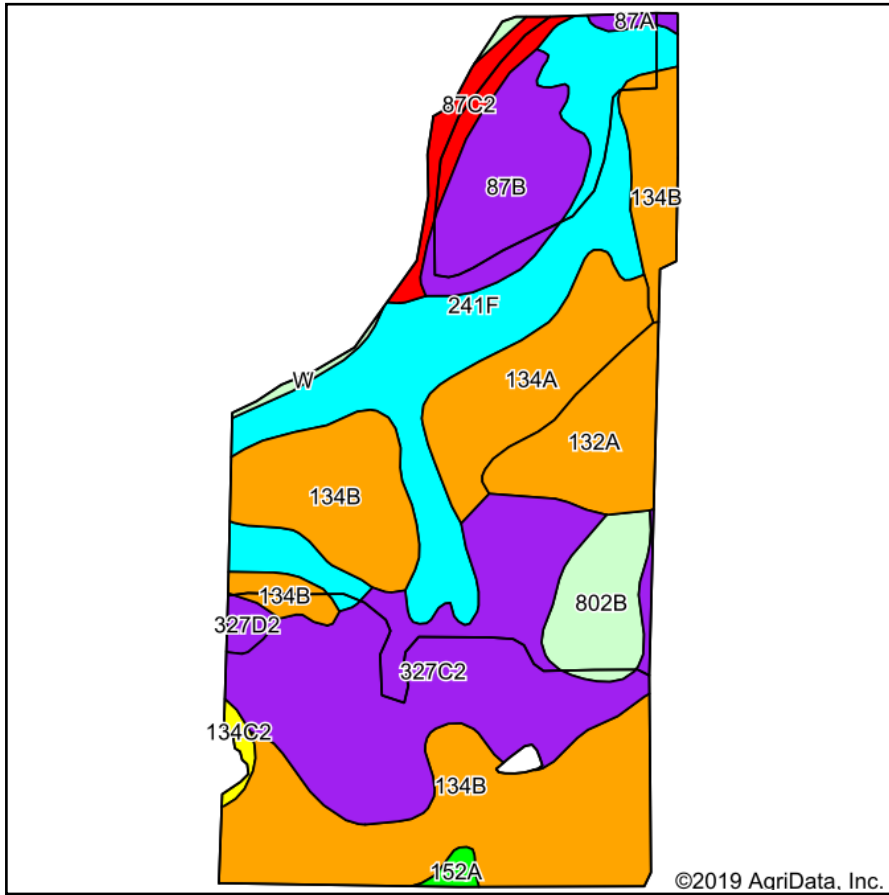

Soils data provided by USDA and NRCS.

©2019 AgriData, Inc.

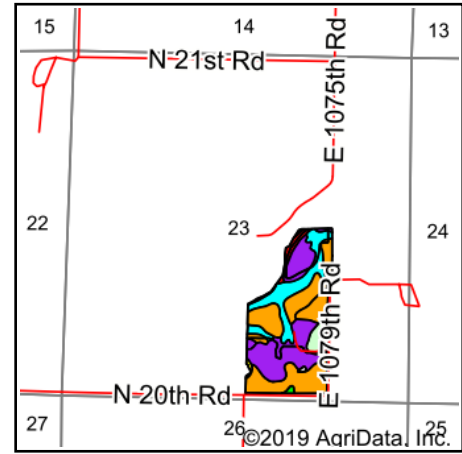

State: **Illinois**
 County: **La Salle**
 Location: **23-32N-2E**
 Township: **Deer Park**
 Acres: **61.63**
 Date: **3/21/2019**

Maps Provided By:



© AgriData, Inc. 2019

www.AgridataInc.com



Area Symbol: IL099, Soil Area Version: 14

Code	Soil Description	Acres	Percent of field	Il. State Productivity Index Legend	Subsoil rooting	Corn Bu/A	Soybeans Bu/A	Wheat Bu/A	Oats Bu/A	Sorghum c Bu/A	Alfalfa d hay, T/A	Grass-leg ume e hay, T/A	Crop productivity index for optimum management
**134B	Camden silt loam, 2 to 5 percent slopes	17.38	28.2%		FAV	**164	**50	**63	**86	0	**4.72	0.00	**118
**327C2	Fox silt loam, 4 to 6 percent slopes, eroded	13.64	22.1%		FAV	**142	**46	**56	**69	0	**3.33	0.00	**104
**241F	Chatsworth silty clay loam, 20 to 30 percent slopes	11.45	18.6%		UNF	**78	**28	**28	**31	0	0.00	**2.51	**59
**87B	Dickinson sandy loam, 2 to 5 percent slopes	4.80	7.8%		FAV	**141	**46	**55	**73	0	**3.36	0.00	**103
134A	Camden silt loam, 0 to 2 percent slopes	4.74	7.7%		FAV	166	51	64	87	0	4.77	0.00	119
132A	Starks silt loam, 0 to 2 percent slopes	3.70	6.0%		FAV	163	51	63	84	0	5.14	0.00	119
802B	Orthents, loamy, undulating	2.72	4.4%		CROP YIELD DATA NOT AVAILABLE						.00	.00	
**87C2	Dickinson sandy loam, 5 to 10 percent slopes, eroded	1.64	2.7%		FAV	**132	**43	**52	**69	0	**3.15	0.00	**97
**327D2	Fox loam, 6 to 12 percent slopes, eroded	0.43	0.7%		FAV	**139	**45	**55	**68	0	**3.26	0.00	**101

W	Water	0.31	0.5%										
**134C2	Camden silt loam, 5 to 10 percent slopes, eroded	0.29	0.5%		FAV	**154	**47	**60	**81	0	**4.44	0.00	**111
152A	Drummer silty clay loam, 0 to 2 percent slopes	0.28	0.5%		FAV	195	63	73	100	0	0.00	5.64	144
87A	Dickinson sandy loam, 0 to 2 percent slopes	0.25	0.4%		FAV	142	46	56	74	0	3.39	0.00	104
Weighted Average						132.3	42.2	50.9	66.1	*-	3.10	0.45	96.4

Table: Optimum Crop Productivity Ratings for Illinois Soil by K.R. Olson and J.M. Lang, Office of Research, ACES, University of Illinois at Champaign-Urbana. Version: 1/2/2012 Amended Table S2 B811

Crop yields and productivity indices for optimum management (B811) are maintained at the following NRES web site: <http://soilproductivity.nres.illinois.edu/>

** Indexes adjusted for slope and erosion according to Bulletin 811 Table S3

a UNF = unfavorable; FAV = favorable

b Soils in the southern region were not rated for oats and are shown with a zero "0".

c Soils in the northern region or in both regions were not rated for grain sorghum and are shown with a zero "0".

d Soils in the poorly drained group were not rated for alfalfa and are shown with a zero "0".

e Soils in the well drained group were not rated for grass-legume and are shown with a zero "0".

*c: Using Capabilities Class Dominant Condition Aggregation Method

Soils data provided by USDA and NRCS. Soils data provided by University of Illinois at Champaign-Urbana.